

Nani - Sectional door. Lifting door fitting Type VL.

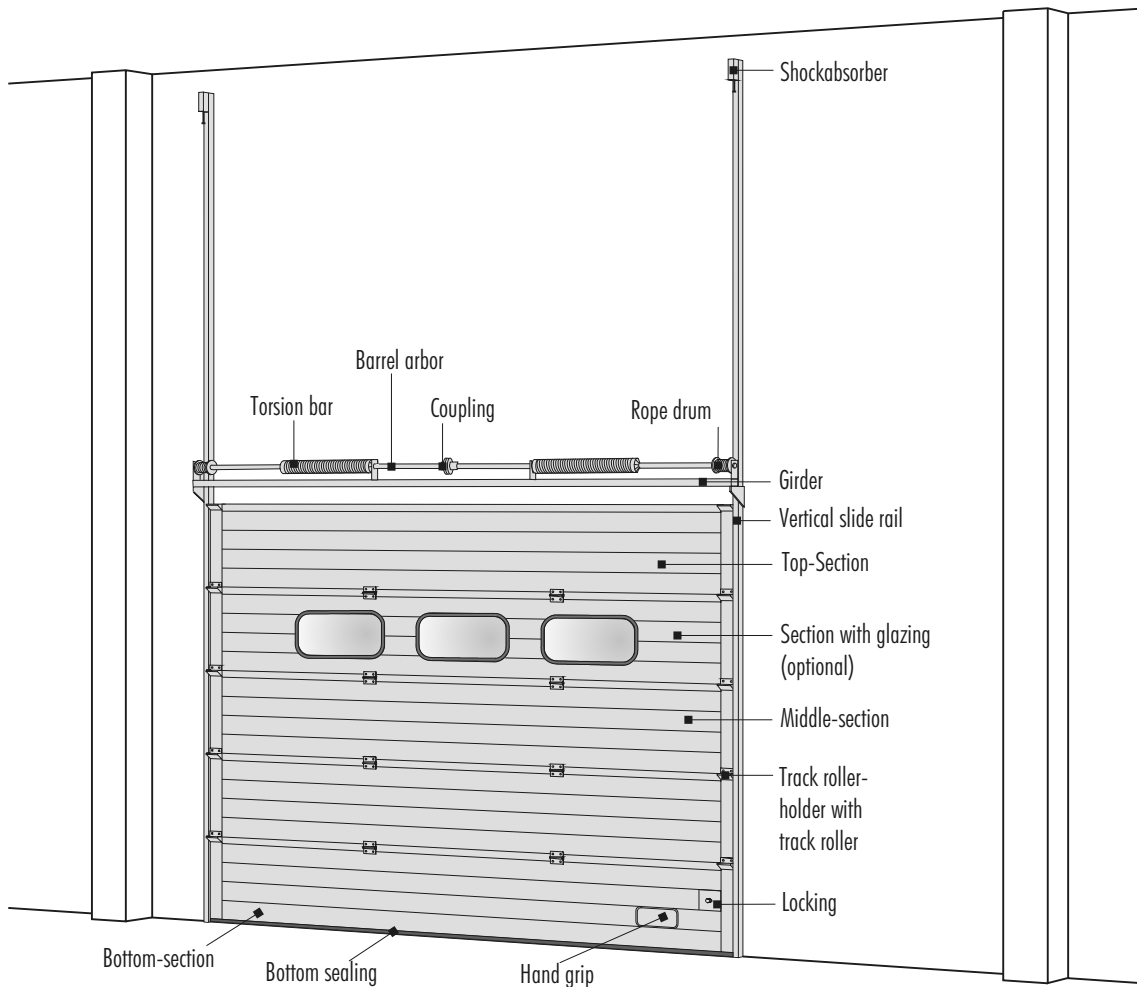

Fitting for perpendicular-current doors VL.

The fitting VL is used, if there is a so large fall free space that the door can be perpendicularly opened.

Due to the not necessary detour into the horizontal, this fitting is particularly low-maintenance and for an easy manual control suitably.

The door is suitable for an easy manual control. The torsion bars needed for balancing the door page are non-standard calculated and manufactured on most modern feather/spring machines.

The sectional doors are manufactured non-standard for each door opening from formed aluminum or galvanized steel sheet. High-insulating CFC-free polyurethan-foam, which creates the chemical network between front and back sheet, makes the section doubly self-supporting. The number of window sections can be varied as required - also combination and placing can be determined individually.

As door with an electric drive it corresponds to the safety regulations of the professional association, the "Guidelines for strength-operated windows, doors and gates" after ZH 1/494, always in the newest case version.

Changes to specification maybe made without prior notification.

ST6-9407-E

Nani
VERLADETECHNIK

...for optimal loading

<http://www.nani.de> E-mail: info@nani.de

Nani Verladetechnik GmbH & Co. KG
Siegerslebener Str. 12, D-39365 Eilsleben
Tel: (039 409) 914 0, Fax: (039 409) 345

Nani - Sectional Door. Lifting door fitting Type VL.

Lifting door fitting (Example)

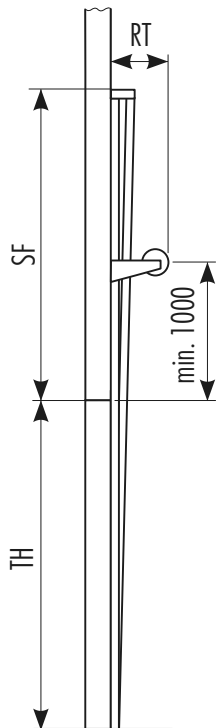

TB = max. 10000 mm, clearance door width

TH = max. 7400 mm, clearance door height

SF = TH + 500 mm, lintel-free space

RT = 600 mm, required space

Free space on the right side min. 100 mm

Free space on the left side min. 100 mm

At the use of an E-propulsion or chain propulsion you need min. 200 mm more space on one side!

A mounting frame is necessary if the door has to be installed at a 'not to burden statically' assembly plant such as trapezium sheet, gas concrete or panels or if there exists no flush limit area!

Special fittings

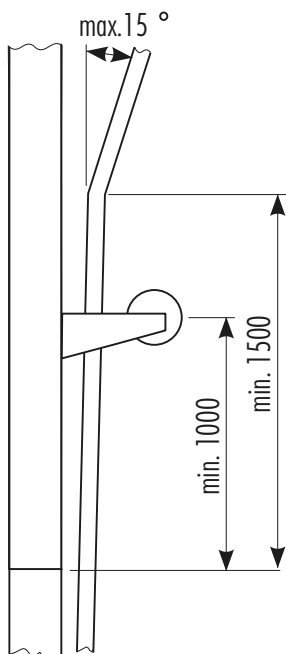

Mounting frame

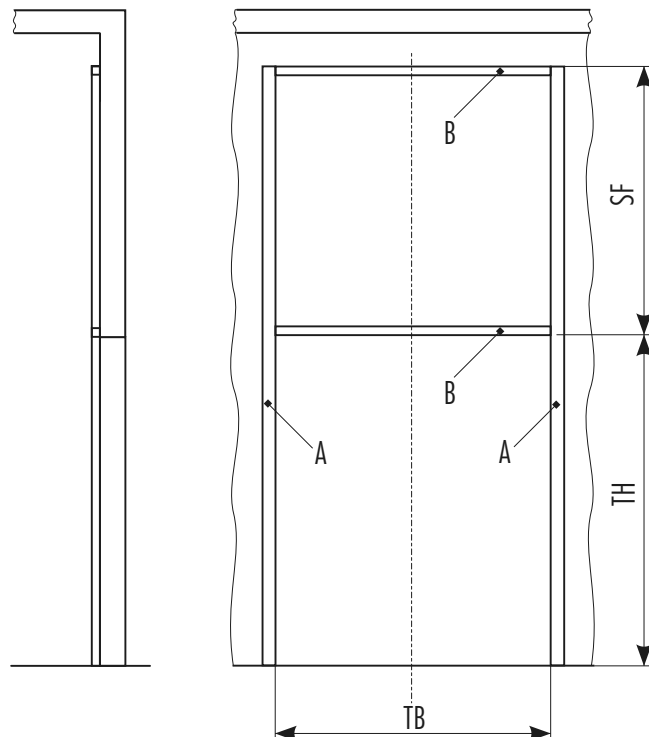

Door limit frame
i.e. rectangular pipe,
80 x 40 x 2 mm

A: 2 piecesL = TH + SF

B: 2 piecesL = TB

Changes to specification maybe made without prior notification.

ST5-2407-E

Nani - Sectional door. Propulsions and Types of section.

E-Propulsion

Size SE 9.24

Propulsion gets adapted to the door-size

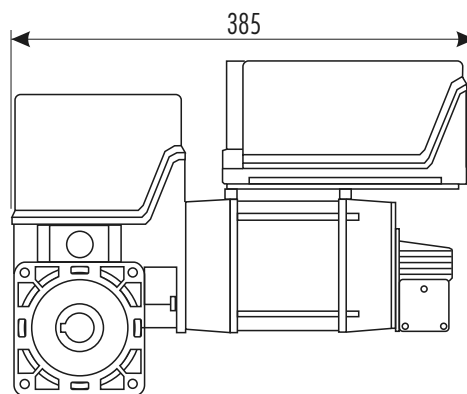
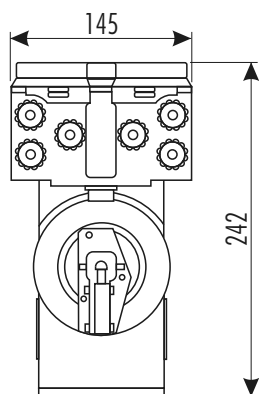

Hollow shaft diameter	mm	25 / 25,4
Drive torque	Nm	90
static holding torque	Nm	240
Door weight upto ca.	N	3000
Engine power	kW	0,37
Operating voltage	V	3 x 230 / 400; 50 Hz
Control voltage	V	230; 50 Hz

Engine-Nominal current	A	2,1 / 1,2
Engine-On-Time	ED	S3 - 60 %
Feedline /Fuse (provided by customer)		5 x 1,5 ² / 10 A delay
Continuous sound pressure level	dB (A)	<70
Protection class	IP	54
ELEKTROMATEN-weight	kg	15

Chain drive

Direct

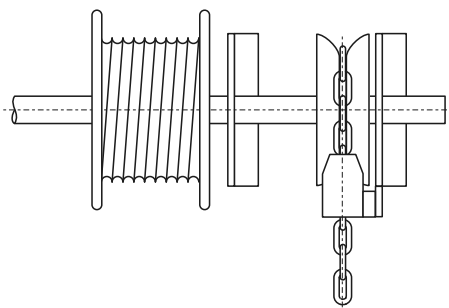

Transformation 1:3
in the gearbox

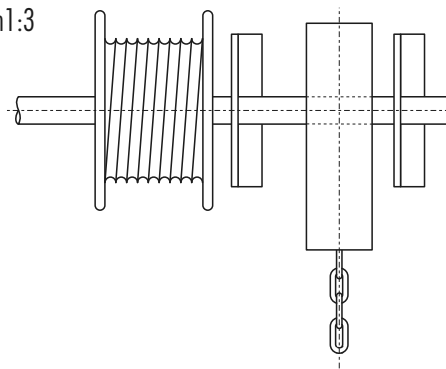

Type of sections

S 40
stucco / flat
with crimping
RAL 9002



S 40 F / R
oval windows
S 40 F / E
rectangular windows

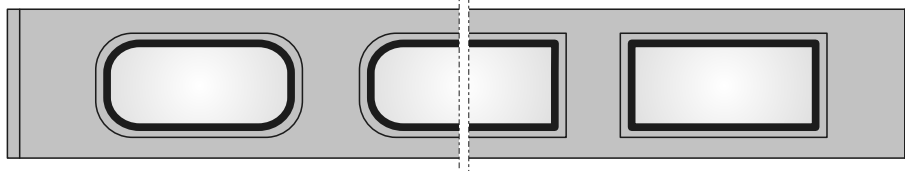

AR
Alu-Frame-
Sections

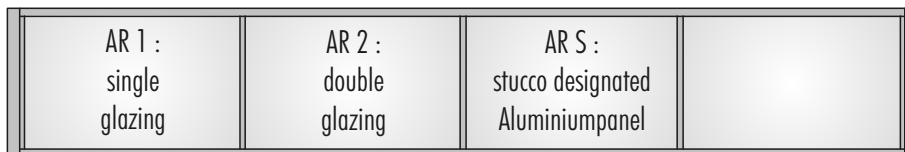

Changes to specification maybe made without prior notification.

ST1-9804-E

Nani
VERLADETECHNIK

...for optimal loading

<http://www.nani.de> E-mail: info@nani.de

Nani Verladetechnik GmbH & Co. KG
Siegerslebener Str. 12, D-39365 Eilsleben
Tel: (039 409) 914 0, Fax: (039 409) 345

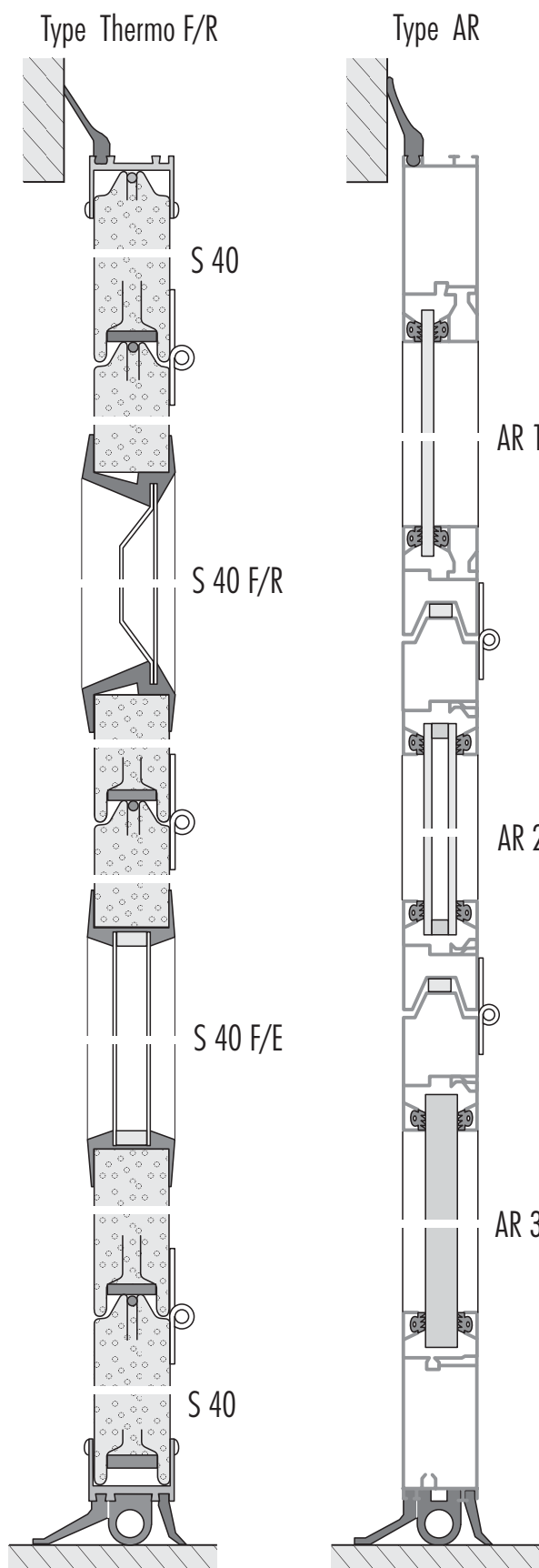

section type	K-value (W/m ² °C)	db-value (db)
S 40	~0,47	~22
S 40 F	~0,75	~19
AR	~2,60	~15

Upper sealing

All doors have a top sealing strip in a fastener. This fastener can be delivered in different versions.

Protects the upper section.

Section sealing

Between the sections is a strong rubber bar mounted. The solutions guarantees an optimal sealing against the wind as well as against driving rain.

Bottom sealing

The door has a special rubber profile with three sealing-lips.

Furthermore serves this bottom sealing as pressure-wave-contact-strip for the E-propulsion.

Side sealing

All insulated doors have a combined guide rail/sealing lip.

It guarantees a maximum sealing and a frictionless function.

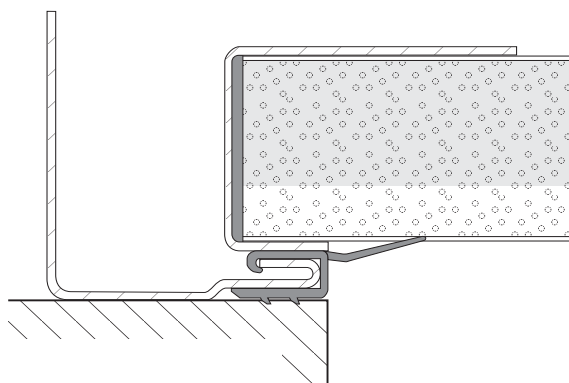

Changes to specification maybe made without prior notification.

S10-2804-E