

NANI-Loading Plate Model SOM

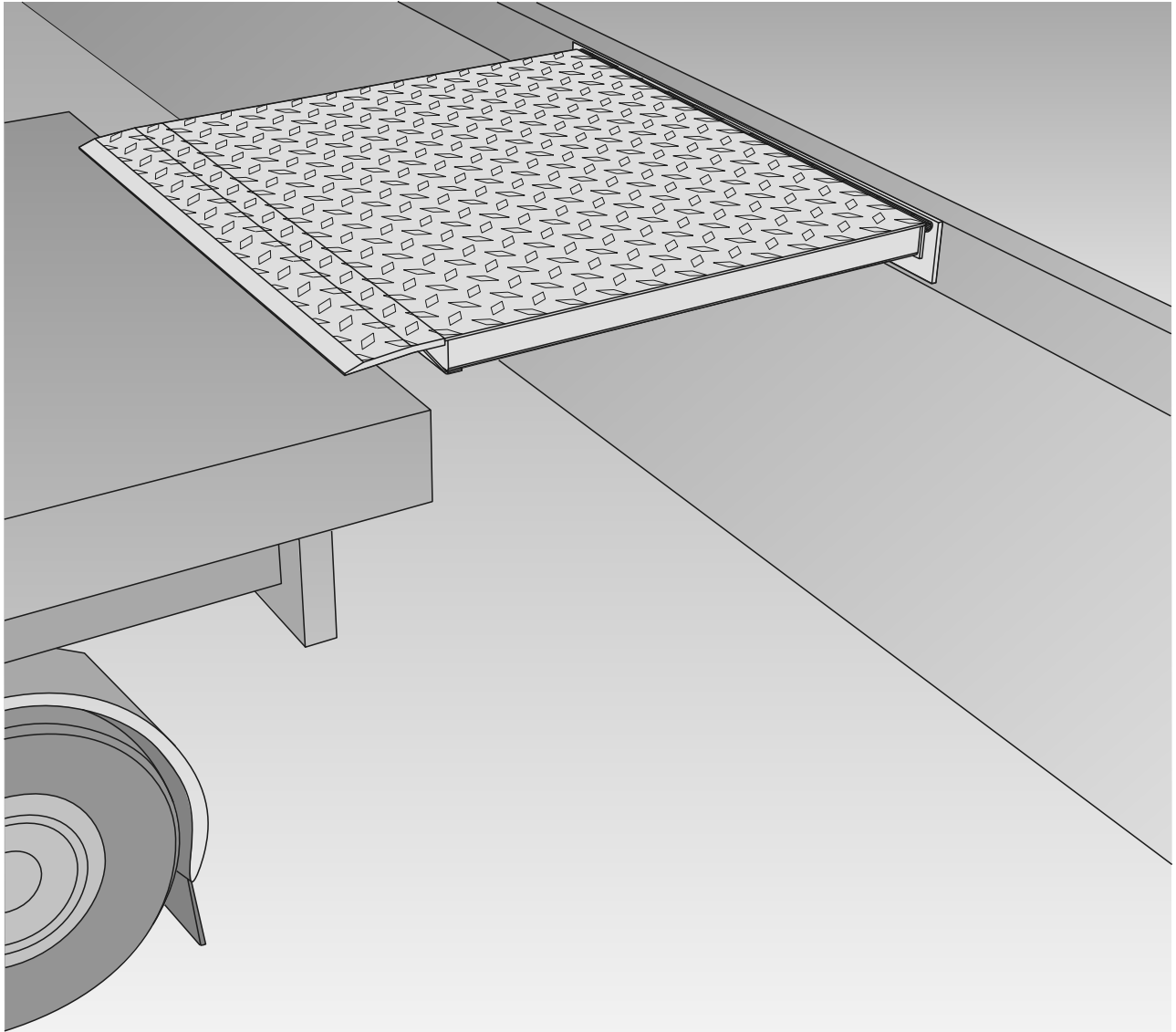

The model SOM is a fixed position loading platform. It is constructed to the highest quality from high grade steel and manufacturing techniques.

The loading dock edge requires a steel profile to be incorporated, thus allowing safe installation and operation of the SOM.

Spring counterbalance is incorporated to the

underside of the platform, this allows lifting and lowering of the platform to be performed in a safe and easy manner.

A safety lock is fitted to facilitate locking in the parked vertical position.

The SOM is manufactured to comply with regulations for docklevellers and loading ramps ZH 1/156 and Euro-Norm EN 1398.

Changes to specification maybe made without prior notification.

SO2.9/405-E



...for optimal loading

<http://www.nani.de> E-mail: info@nani.de

Nani Verladetechnik GmbH & Co. KG
Siegerslebener Str. 12, D-39365 Eilsleben
Tel: (039 409) 914 0, Fax: (039 409) 345

NANI-Loading Plate Model SOM

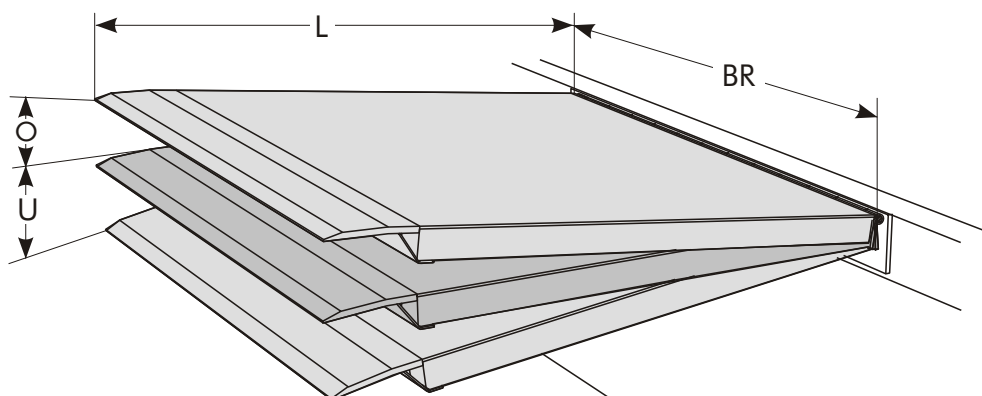
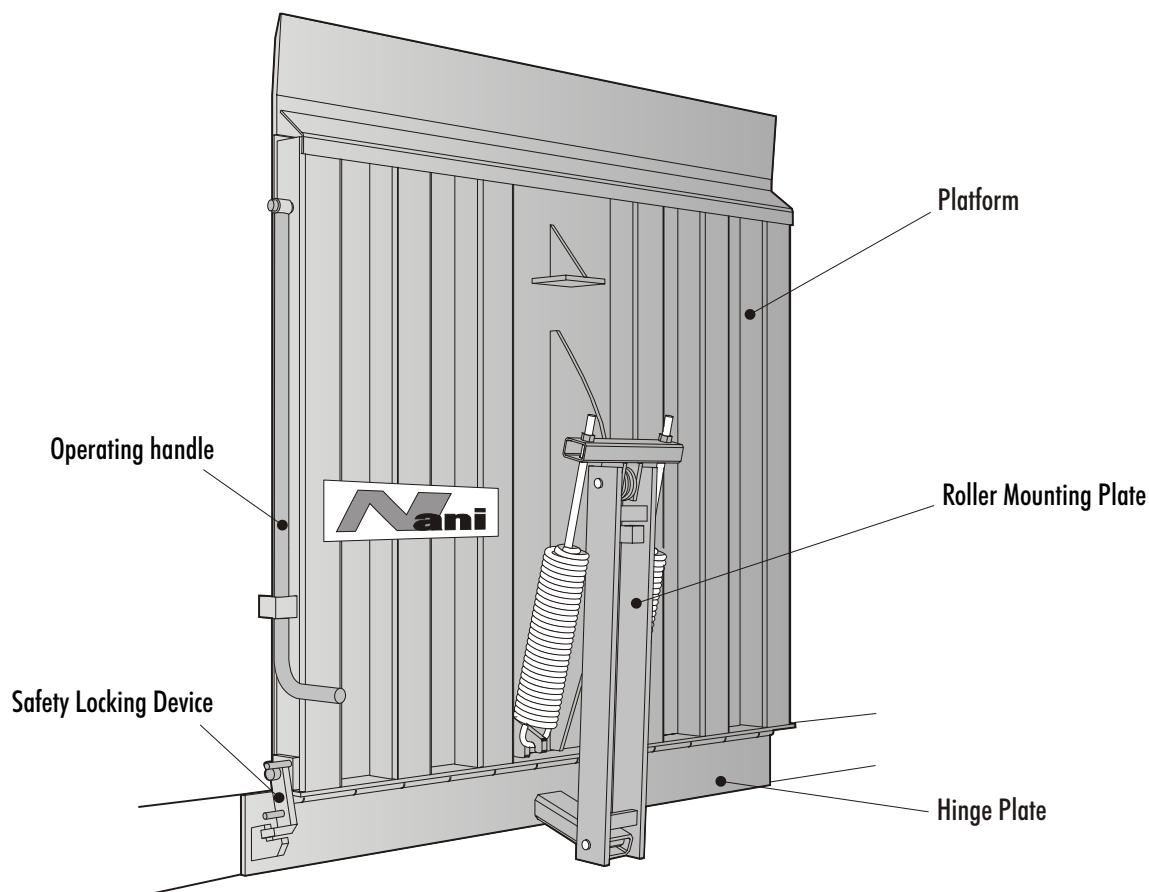

O - Above dock

U - Below dock

Sizes	L	O	U
1	1250	156	156
2	1500	185	185
3	1750	218	218

Load capacity for all sizes 40 kN or 60 kN.
Width (BR) for all sizes 1500, 1750, 2000 mm.

Please ask for assistance on capacity
and size to suit your application.

Changes to specification maybe
made without prior notification.

SO1-2405-1-E



...for optimal loading

<http://www.nani.de> E-mail: info@nani.de

Nani Verladetechnik GmbH & Co. KG
Siegerslebener Str. 12, D-39365 Eilsleben
Tel: (039 409) 914 0, Fax: (039 409) 345

Nani - Dockleveller Type SOM / SVM. Ramp construction.

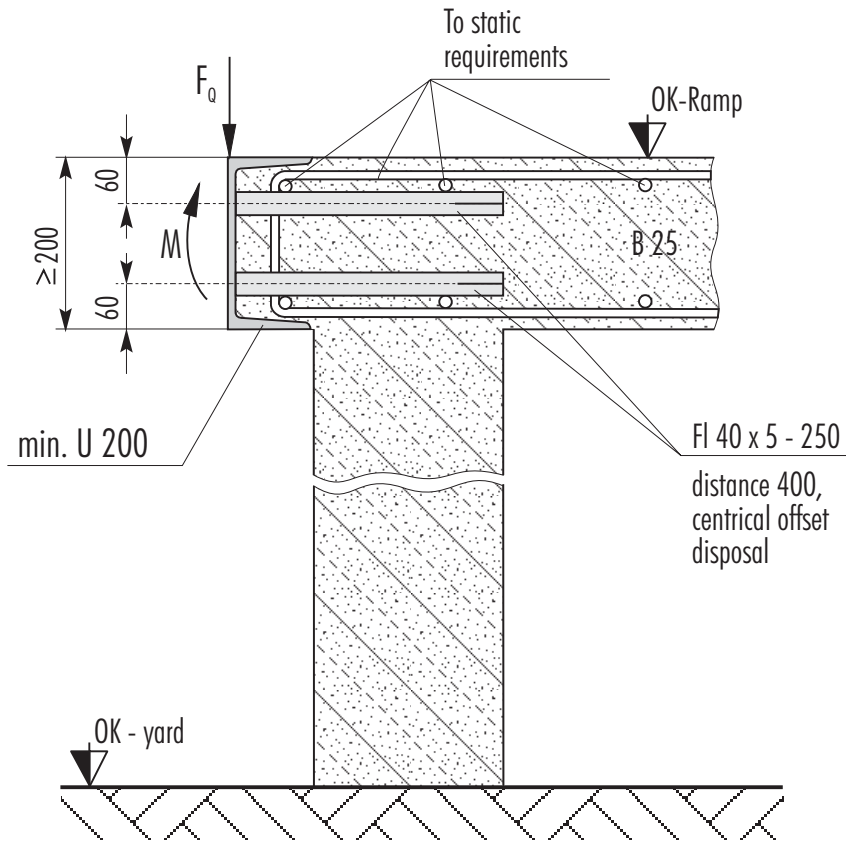

Requirements provided by customer

The steel apron at the front edge of the ramp has to be completed according to the following details.

The steel apron has to be fixed solidly into the ramp and completed according to the following static requirements.

$$\text{Transverse force } F_q = \text{Capacity} \times 1.6 \text{ (vibration coefficient j)}$$

Changes to specification maybe made without prior notification.

Leveller size	Leveller length mm	Maximalum bending moment M for leveller width B			
		B = 1500mm M (kNm)	B = 1750mm M (kNm)	B = 2000mm M (kNm)	B = 2250mm M (kNm)
1	1250	5.4	6.3	7.5	8.6
2	1500	8.3	9.0	10.1	11.2
3	1750	11.4	12.3	13.6	14.8
4	2000	14.0	16.0	17.0	18.0

RP1-9402



...for optimal loading

<http://www.nani.de> E-mail: info@nani.de

Nani Verladetechnik GmbH & Co. KG
Siegelslebener Str. 12, D-39365 Eilsleben
Tel: (039 409) 914 0, Fax: (039 409) 345